

MOT-130 FL86STH80-5504B Stepper Motor Specifications
MOT-132 FL86STH118-6004B Stepper Motor Specifications
MOT-135 FL86STH156-6204B Stepper Motor Specifications

1.8° Size 86mm High Torque Hybrid Stepping Motor

Item	Specifications
Step Angle	1.8°
Step Angle Accuracy	±5% (full step, no load)
Resistance Accuracy	±10%
Inductance Accuracy	±20%
Temperature Rise	80° C Max.(rated current,2 phase on)
Ambient Temperature	-20° C~+50° C
Insulation Resistance	100MΩMin.,500VDC
Dielectric Strength	820VAC, 1s, 3mA
Shaft Radial Play	0.02Max. (450 g-load)
Shaft Axial Play	0.08Max. (450 g-load)
Max. radial force	220N (20mm from the flange)
Max. axial force	60N

1 Size 86mm High Torque Hybrid Stepping Motor Specifications

Model No.		Current /Phase	Resistance /Phase	Inductance /Phase	Holding Torque (Bipolar)	# of Leads	Rotor Inertia	Weight	Detent Torque	Length
Single Shaft	Double Shaft	A	Ω	mH	Kg·cm	#	g·cm ²	kg	kg·cm	mm
FL86STH65-5904A	FL86STH65-5904B	5.9	0.28	1.7	34	4	1000	1.7	0.8	65
FL86STH65-2808A	FL86STH65-2808B	2.8	1.4	3.9	34	8				
FL86STH80-5504A	FL86STH80-5504B	5.5	0.46	4	46	4	1400	2.3	1.2	80
FL86STH80-4208A	FL86STH80-4208B	4.24	0.75	3.4	46	8				
FL86STH118-6004A	FL86STH118-6004B	6	0.6	6.5	87	4	2700	3.8	2.4	118
FL86STH118-4208A	FL86STH118-4208B	4.2	0.9	6	87	8				
FL86STH156-6204A	FL86STH156-6204B	6.2	0.75	9	122	4	4000	5.4	3.6	156
FL86STH156-4208A	FL86STH156-4208B	4.2	1.25	8	122	8				

1 Dimension

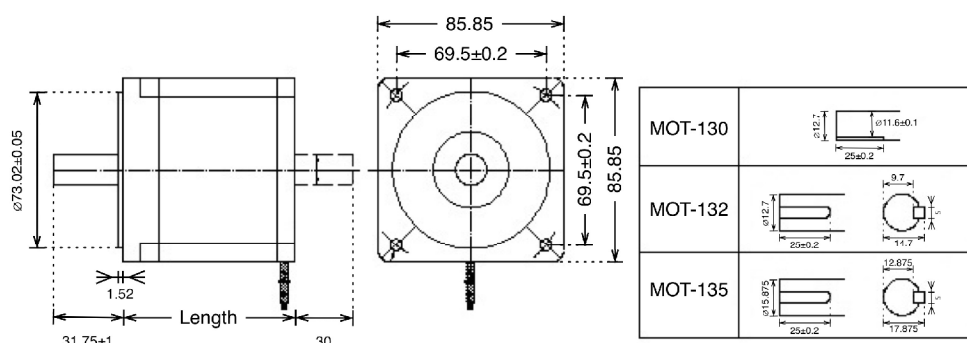

• WIRE DIAGRAM

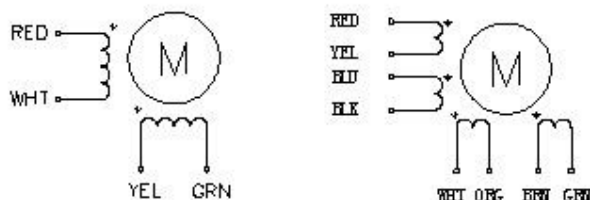

MOT-130

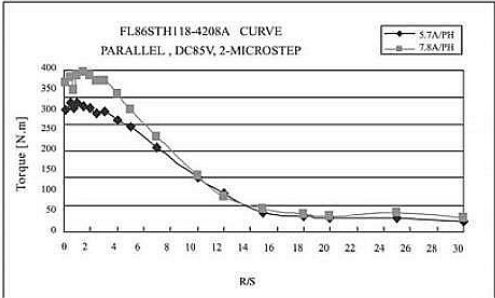
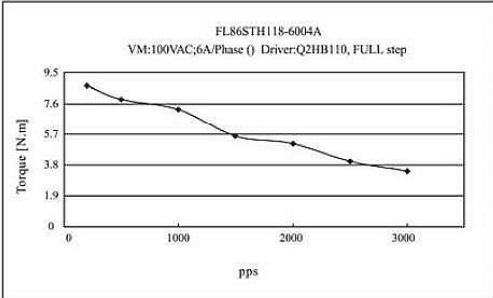
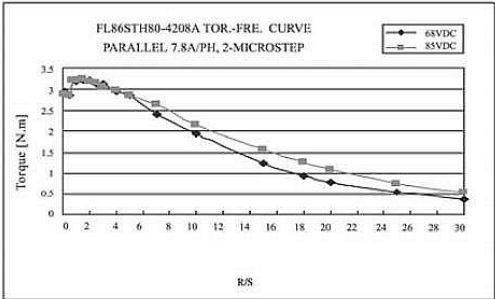
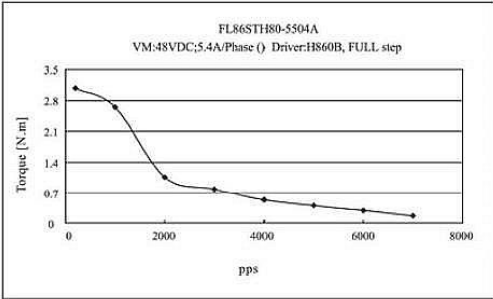

MOT-135

